

## Standard rubber bollard with Led light and built –in transformer

Total length 1350 mm  
Height above ground 750 mm  
Diameter foot 187 mm  
Diameter foundation 200 mm  
Lamp width 50 mm  
Weight 40 kg  
Bending force (45°) 300 kg  
Light 12 volt LED chain  
Polycarbonate screen

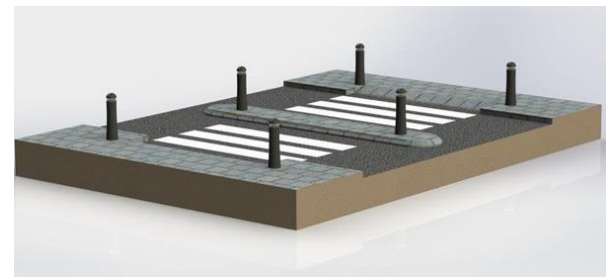

## Standard Rubber Bollard with LED light and built-in transformer .

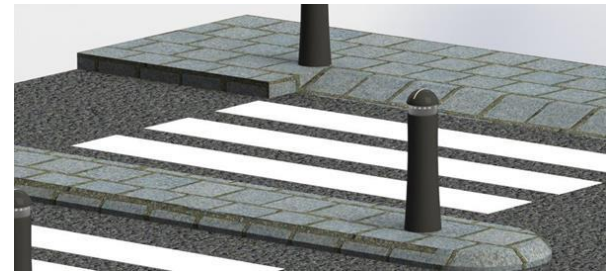
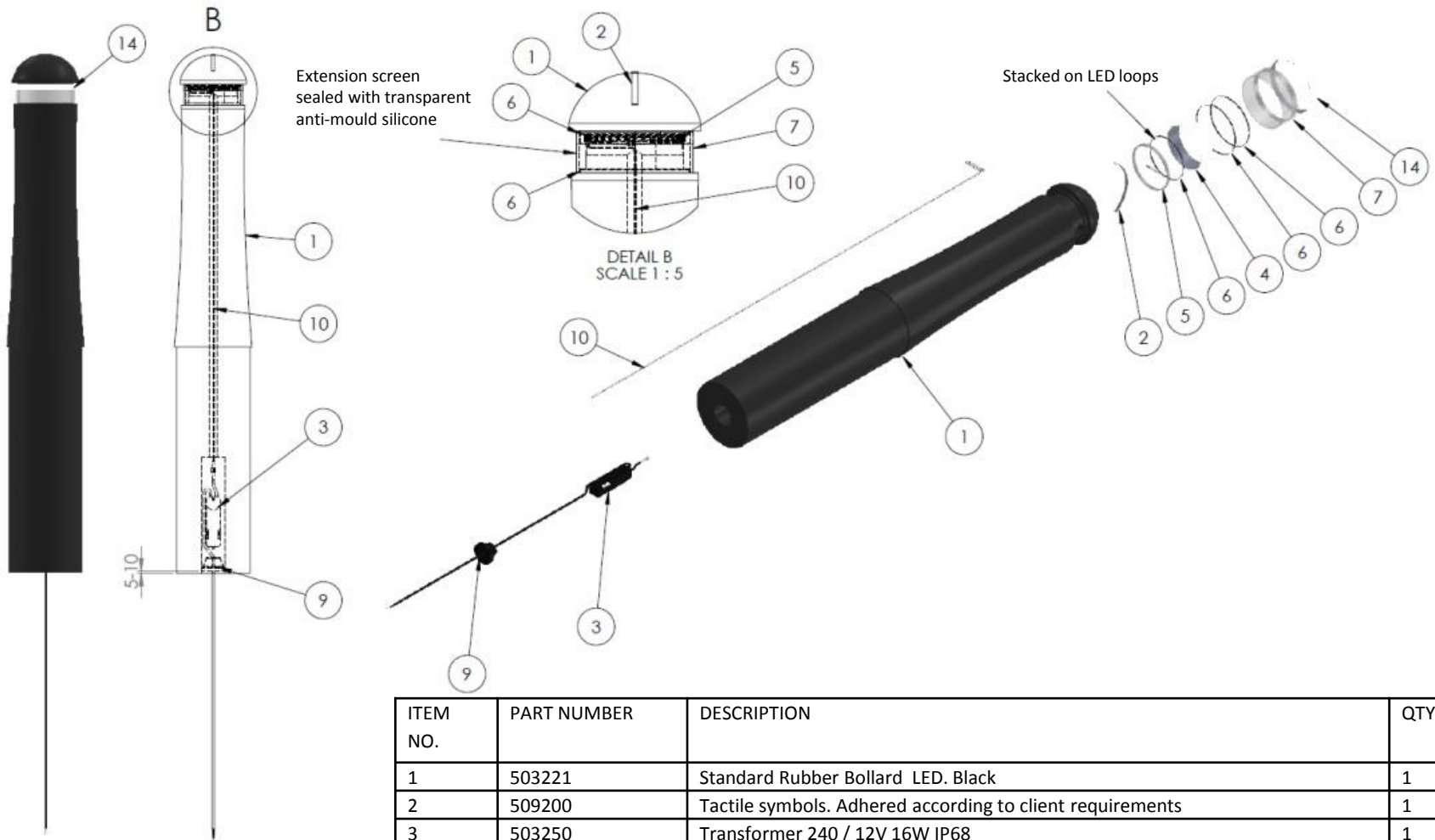

ITEM NO.	PART NUMBER	DESCRIPTION	QTY.
1	503221	Standard Rubber Bollard LED. Black	1
2	509200	Tactile symbols. Adhered according to client requirements	1
3	503250	Transformer 240 / 12V 16W IP68	1
4	503225	Reflective tape. White . Dim : 430x43mm	1
5	503230	LED warm white loop . 12V DC	1
6	503270	Double-sided tape DHT. B = 4mm t = 0.6mm . Black.	3
7	503240/503241	Screen . PC UV-resistant . Ø150mm t = 4mm h = 53mm	1
9	503262	Rubber grommet. Ø 60,5mm	2
10	503267	Extension cable . l = 1.5m , male & female	1
14	503226	Reflective tape . White . Dim : 16x500mm	1

## Standard Rubber Bollard with LED lighting and external transformer

- Connect the client's cable with an extension cable.
- Install joint kit as instructed.
- Pull the clients cable through the small hole at the bottom of rubber grommet.
- Push cable and joint kit inside the bollard to grip and seal.

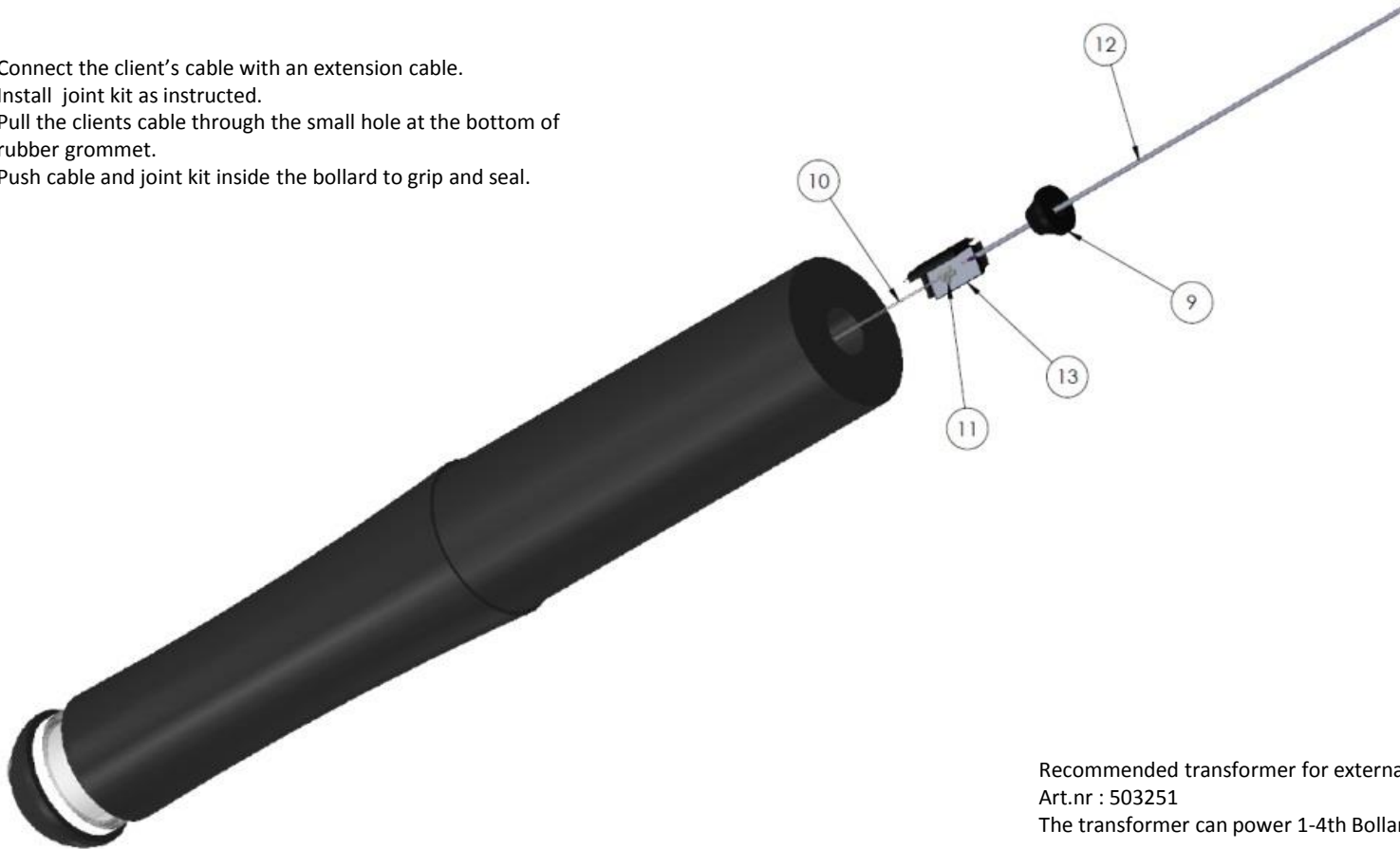

Recommended transformer for external operation .

Art.nr : 503251

The transformer can power 1-4th Bollard

Maximum size of a cable splice  
to fit inside joint kit

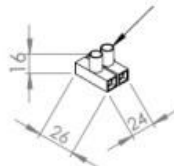

ITEM NO.	PART NUMBER	DESCRIPTION	QTY
9	503262	Rubber grommet . Ø 60,5mm .	1
10	503267	Extension cable . l = 1.5m , male & female	1
11	KABLE-SPLICE	Depending on cable selection, adapter sleeves are not included.	1
12	CUSTOM CABLE	Examples of cable. Type: Steering Cable 2x2,5mm <sup>2</sup> E-83087840 (Not included)	1
13	503260	Joint kit with gel and connector	1